



Ce document a été numérisé par le CRDP
d'Alsace pour la Base Nationale des Sujets
d'Examens de l'enseignement
professionnel

CAP PRÉPARATION ET RÉALISATION D'OUVRAGES ÉLECTRIQUES

SESSION 2011

ÉPREUVE EP1
COMMUNICATION TECHNIQUE

DOSSIER TECHNIQUE

N° d'inscription du candidat : _____

	Session	2011	Facultatif : code	D510-ZM176
Examen et spécialité				
CAP Préparation et Réalisation d'Ouvrages Electriques				
Intitulé de l'épreuve				
EP1 Communication technique				
Type	Facultatif : date et heure	Durée	Coefficient	N° de page / total
DOSSIER TECHNIQUE		3 h 00	4	DT 1 / 9

PLAN DE MASSE

Echelle: $\frac{1}{200}$

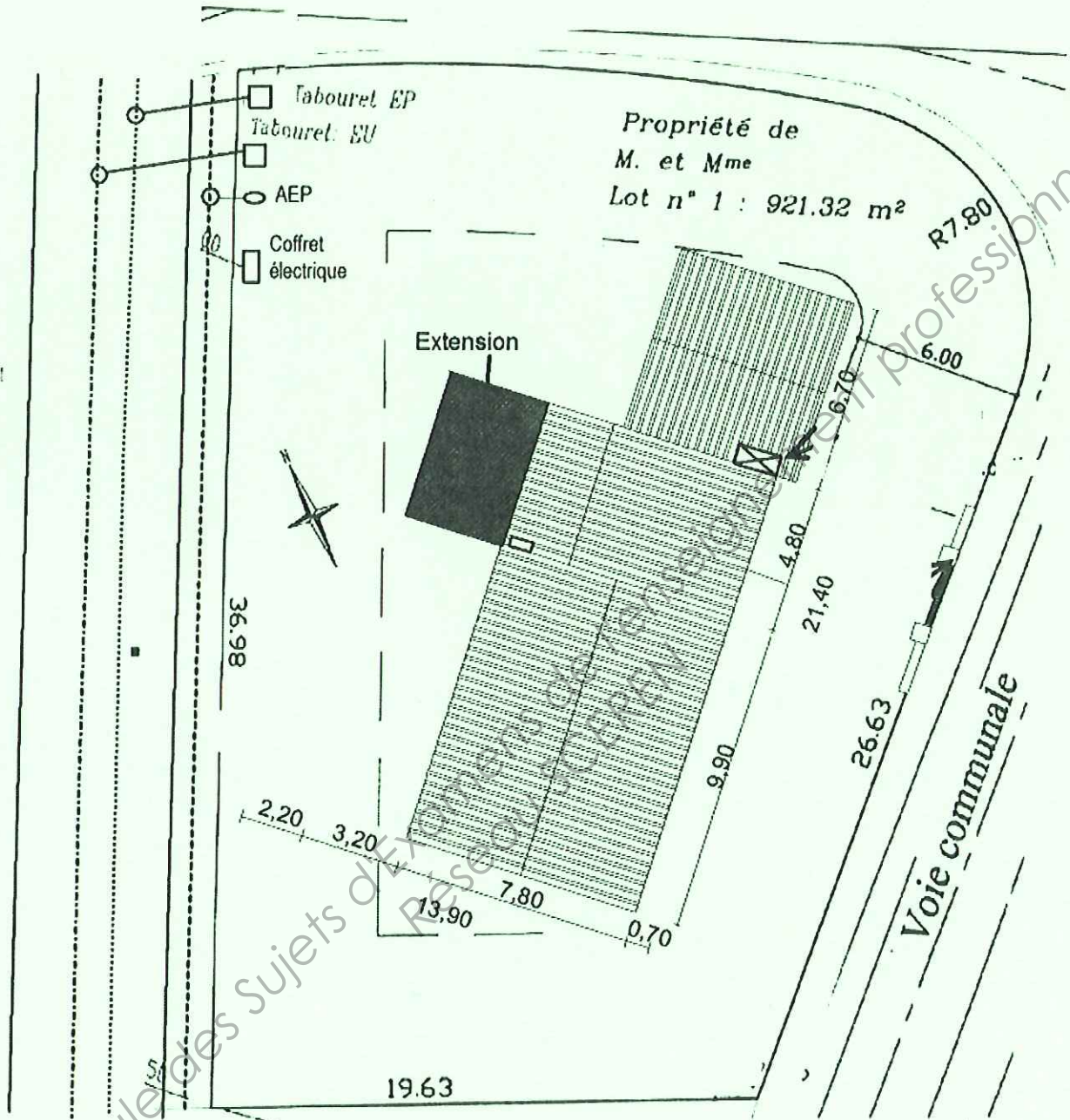

Vue arrière de l'habitation:

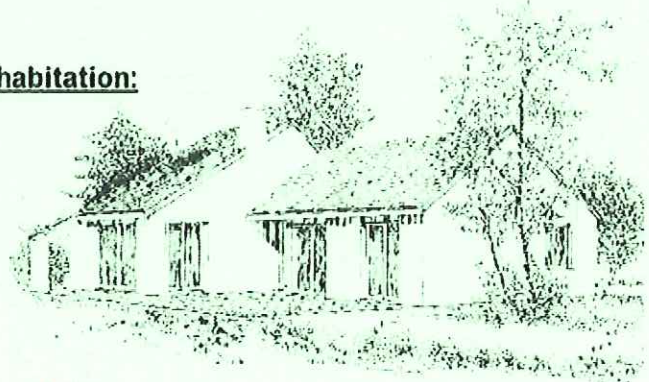

PLAN ARCHITECTURAL DU REZ DE CHAUSSEE DU PAVILLON AVANT TRAVAUX

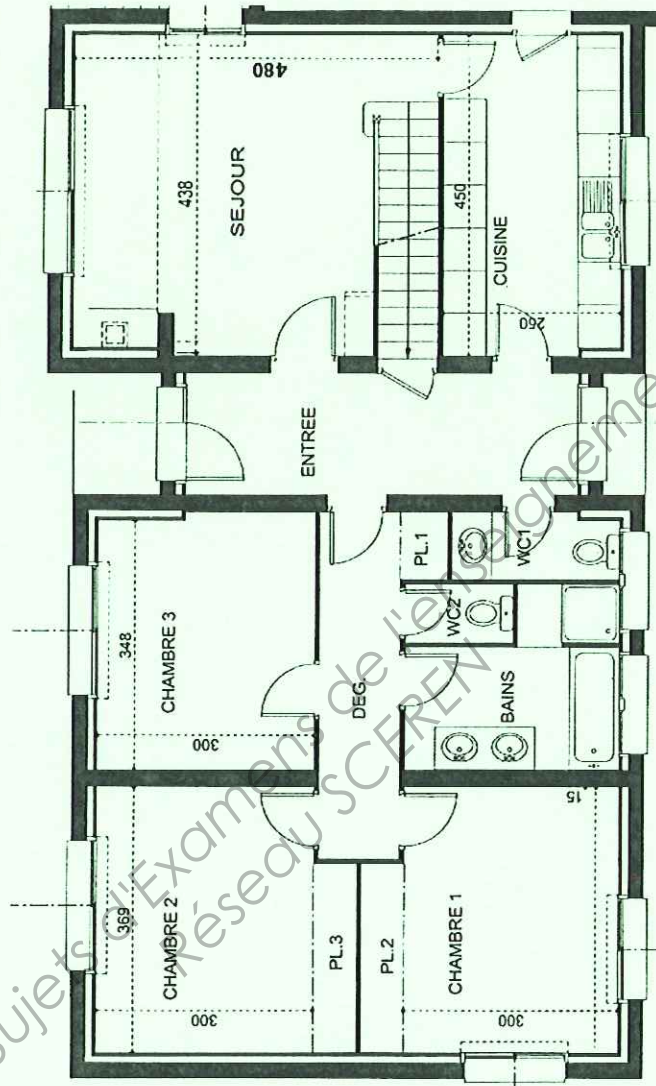

Échelle : 1 / 100

PLAN ARCHITECTURAL DU REZ DE CHAUSSEE DU PAVILLON APRES TRAVAUX

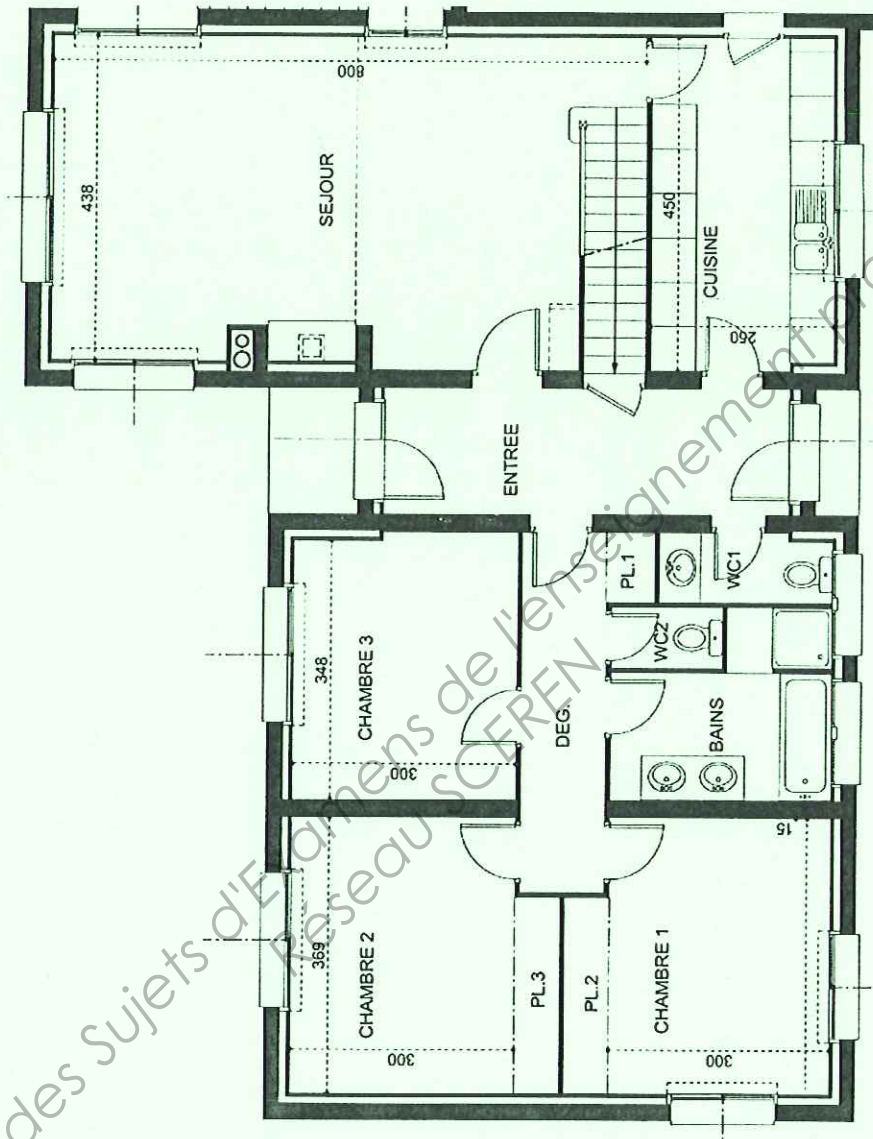

Échelle : 1 / 100

SCHÉMA ARCHITECTURAL DU REZ DE CHAUSSÉE DU PAVILLON AVANT TRAVAUX











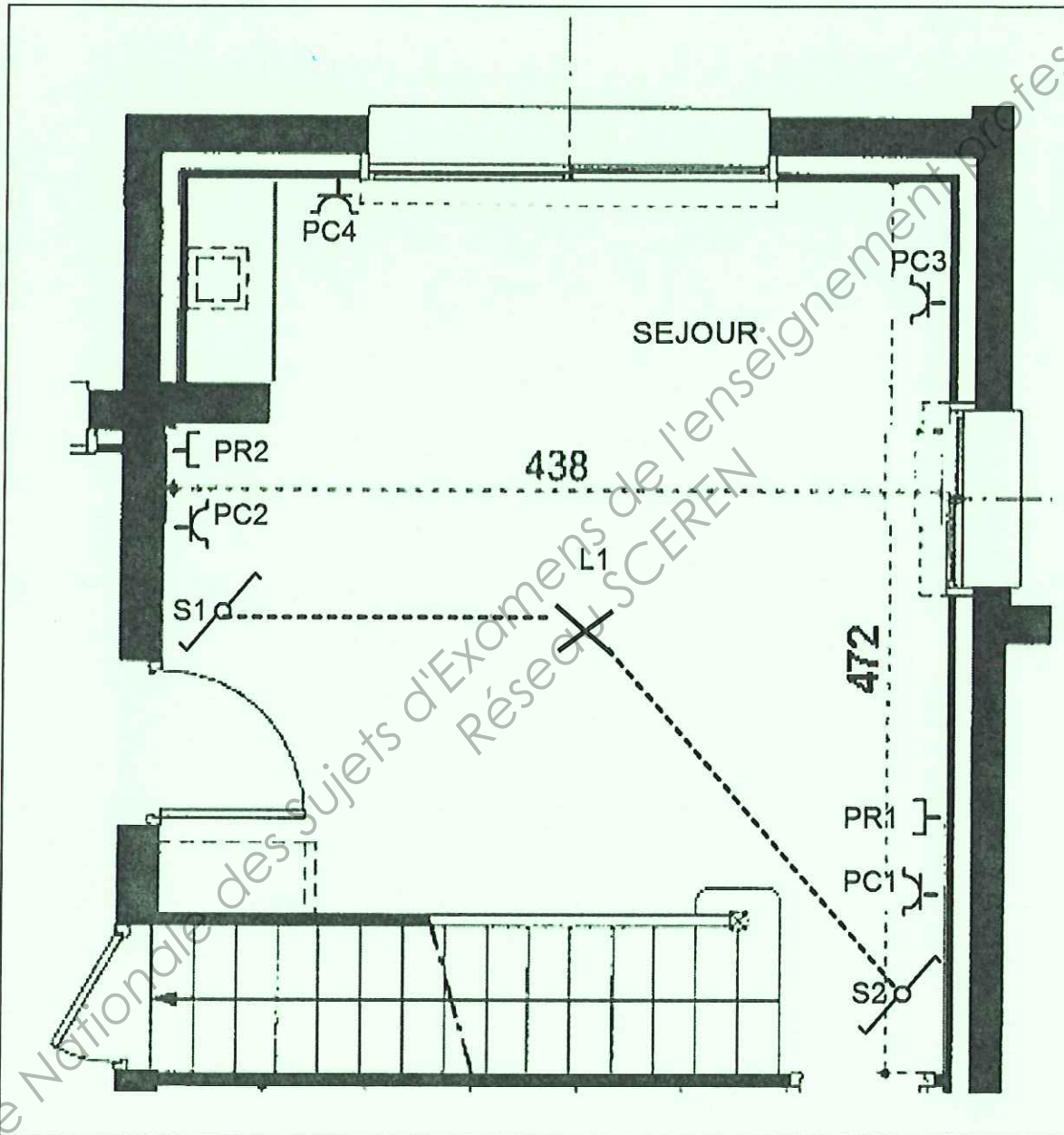
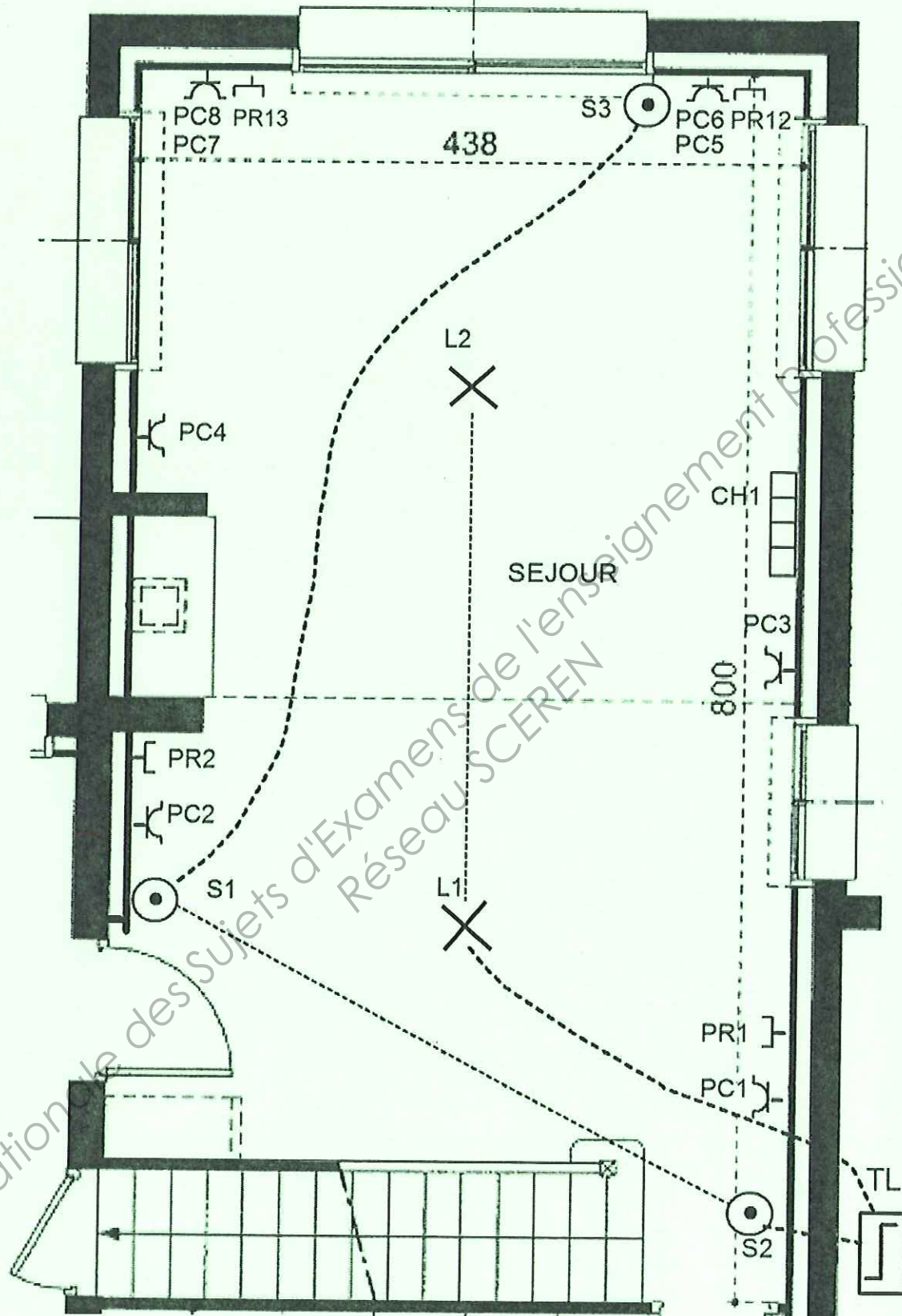















SCHÉMA ARCHITECTURAL DU REZ DE CHAUSSÉE DU PAVILLON APRES TRAVAUX



PLAN D'IMPLANTATION DU TABLEAU ÉLECTRIQUE AVANT TRAVAUX

①													①	
Protection différentielle rangée 1	Prises courant Séjour / repas		Eclairage Séjour / repas											
<input checked="" type="checkbox"/> <input checked="" type="checkbox"/> <input checked="" type="checkbox"/> <input checked="" type="checkbox"/> ID10  40A / 30mA Type AC	<input checked="" type="checkbox"/> <input checked="" type="checkbox"/> Q11 	<input checked="" type="checkbox"/> <input checked="" type="checkbox"/> Q12 	Modules non utilisés											
Protection différentielle rangée 2	Plaques cuisson Cuisine		Lave-linge Garage	Lave-vaisselle Cuisine	Prises courant Garage / ch. 3	Eclairage Cuis. / Garage	Eclairage Chambres	Sonnette Entrée	Transformateur Sonnette					
<input checked="" type="checkbox"/> <input checked="" type="checkbox"/> <input checked="" type="checkbox"/> <input checked="" type="checkbox"/> ID20  25A / 30mA Type A	<input checked="" type="checkbox"/> <input checked="" type="checkbox"/> Q21  32A	<input checked="" type="checkbox"/> <input checked="" type="checkbox"/> Q22  20A	<input checked="" type="checkbox"/> <input checked="" type="checkbox"/> Q23  20A	<input checked="" type="checkbox"/> <input checked="" type="checkbox"/> Q24  20A	<input checked="" type="checkbox"/> <input checked="" type="checkbox"/> Q25  16A	<input checked="" type="checkbox"/> <input checked="" type="checkbox"/> Q26  16A	<input checked="" type="checkbox"/> <input checked="" type="checkbox"/> Q27  2A	<input checked="" type="checkbox"/> <input checked="" type="checkbox"/> <input checked="" type="checkbox"/> <input checked="" type="checkbox"/>	<input checked="" type="checkbox"/> <input checked="" type="checkbox"/> <input checked="" type="checkbox"/> <input checked="" type="checkbox"/>	Modules non utilisés				
Protection différentielle rangée 3	Prises courant Chambres 1 et 2	Prises courant Ent. / Dég. / SdB	Chaudière	Four Cuisine	Chauffe-eau Pl. 1	Protection Relais jour/nuit	Relais jour/nuit Chauffe-eau	Eclairage Ent./Dég./SdB/WC	Télérupteur Eclair. Entrée	Prises courant Cuisine	VMC Cuisine			
<input checked="" type="checkbox"/> <input checked="" type="checkbox"/> <input checked="" type="checkbox"/> <input checked="" type="checkbox"/> ID30  40A / 30mA Type AC	<input checked="" type="checkbox"/> <input checked="" type="checkbox"/> Q31  20A	<input checked="" type="checkbox"/> <input checked="" type="checkbox"/> Q32  20A	<input checked="" type="checkbox"/> <input checked="" type="checkbox"/> Q33  20A	<input checked="" type="checkbox"/> <input checked="" type="checkbox"/> Q34  20A	<input checked="" type="checkbox"/> <input checked="" type="checkbox"/> Q35  20A	<input checked="" type="checkbox"/> <input checked="" type="checkbox"/> Q36  2A	<input checked="" type="checkbox"/> <input checked="" type="checkbox"/> K30 	<input checked="" type="checkbox"/> <input checked="" type="checkbox"/> Q37  16A	<input checked="" type="checkbox"/> <input checked="" type="checkbox"/> TL30 	<input checked="" type="checkbox"/> <input checked="" type="checkbox"/> Q38  20A	<input checked="" type="checkbox"/> <input checked="" type="checkbox"/> Q39  2A			
	<input checked="" type="checkbox"/> <input checked="" type="checkbox"/> <input checked="" type="checkbox"/> <input checked="" type="checkbox"/>	<input checked="" type="checkbox"/> <input checked="" type="checkbox"/> <input checked="" type="checkbox"/> <input checked="" type="checkbox"/>	<input checked="" type="checkbox"/> <input checked="" type="checkbox"/> <input checked="" type="checkbox"/> <input checked="" type="checkbox"/>	<input checked="" type="checkbox"/> <input checked="" type="checkbox"/> <input checked="" type="checkbox"/> <input checked="" type="checkbox"/>	<input checked="" type="checkbox"/> <input checked="" type="checkbox"/> <input checked="" type="checkbox"/> <input checked="" type="checkbox"/>	<input checked="" type="checkbox"/> <input checked="" type="checkbox"/> <input checked="" type="checkbox"/> <input checked="" type="checkbox"/>	<input checked="" type="checkbox"/> <input checked="" type="checkbox"/> <input checked="" type="checkbox"/> <input checked="" type="checkbox"/>	<input checked="" type="checkbox"/> <input checked="" type="checkbox"/> <input checked="" type="checkbox"/> <input checked="" type="checkbox"/>	<input checked="" type="checkbox"/> <input checked="" type="checkbox"/> <input checked="" type="checkbox"/> <input checked="" type="checkbox"/>	<input checked="" type="checkbox"/> <input checked="" type="checkbox"/> <input checked="" type="checkbox"/> <input checked="" type="checkbox"/>	<input checked="" type="checkbox"/> <input checked="" type="checkbox"/> <input checked="" type="checkbox"/> <input checked="" type="checkbox"/>			
①													①	

PLAN DE LA PIEUVRE SITUÉE DANS LES COMBLES AVANT TRAVAUX

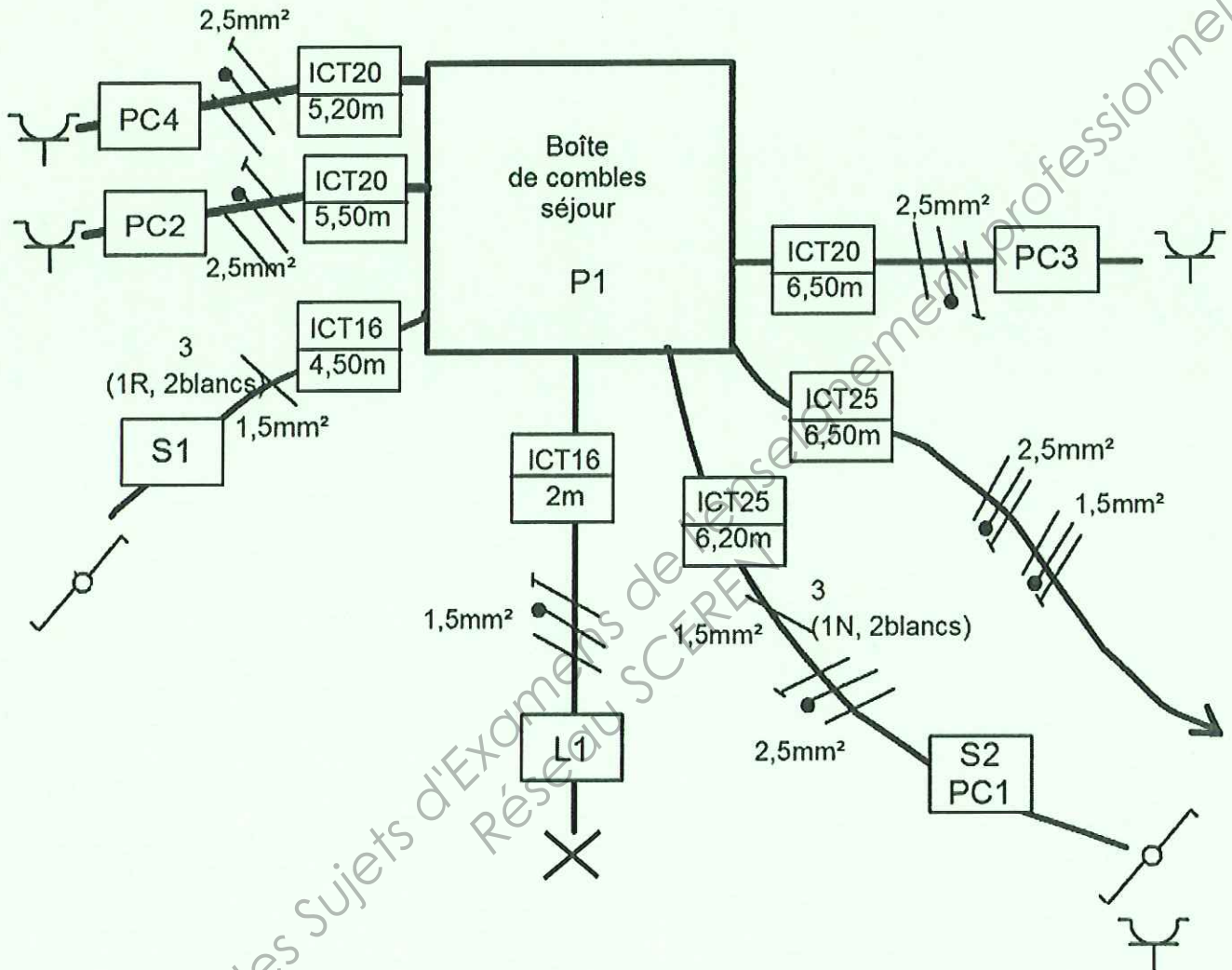

IMPLANTATION DES ÉQUIPEMENTS VDI DANS L'HABITATION

